



Burrow Drive, Rothley, LE7 7RZ



Part of  
**SHELDON  
BOSLEY  
KNIGHT**  
LAND AND  
PROPERTY  
PROFESSIONALS



# Property Description

A VERY WELL PRESENTED AND PROPORTIONED END ONE OF THREE TOWN HOUSES SITUATED ON A SMALL DEVELOPMENT WITHIN THE HIGHLY SOUGHT AFTER VILLAGE OF ROTHLEY. THE PROPERTY IS CONVENIENTLY LOCATED FOR THE VILLAGE PRIMARY SCHOOL AND IS ONLY A SHORT DISTANCE FROM THE VILLAGE CENTRE.

This very well presented end town house offers good sized accommodation and is located in a convenient position with good access to the village centre and amenities.

The accommodation has gas central heating and UPVC double glazed windows and doors and includes entrance hall, cloakroom/w.c., fitted kitchen, lounge/dining room, landing, 2 double bedrooms and bathroom. Outside offers 2 parking spaces to the front of the property and a fully fenced rear garden.

Ideal for first time buyers and investors.







## Key Features

- VERY WELL PRESENTED END ONE OF THREE TOWN HOUSES
- PRIVATE LOCATION IDEAL FOR ACCESS TO THE VILLAGE CENTRE & CONVENIENT FOR THE PRIMARY SCHOOL
- GAS CENTRAL HEATING, UPVC DOUBLE GLAZED WINDOWS AND DOORS
- ENTRANCE HALL, CLOAKROOM/W.C.
- FITTED KITCHEN, LOUNGE/DINING ROOM
- 2 DOUBLE BEDROOMS AND BATHROOM
- 2 DEDICATED PARKING SPACES TO THE FRONT
- FULLY FENCED REAR GARDEN.

**Guide Price**  
**£235,000**







Floor area 30.0 sq.m. (323 sq.ft.) approx

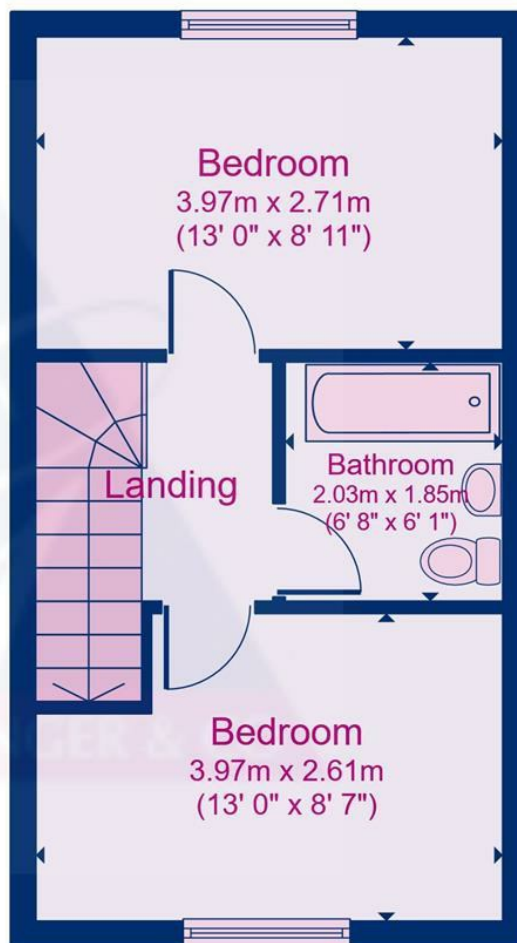

Floor area 30.0 sq.m. (323 sq.ft.) approx

Floor plans are for identification purposes only. All measurements are approximate.  
Created using Vision Publisher™



EPC Rating - C

Tenure - Freehold

Council Tax Band - B

Local Authority  
Charnwood Borough Council





To view this property please contact our Loughborough office on 01509 235534



Part of  
**SHELDON  
BOSLEY  
KNIGHT**  
LAND AND  
PROPERTY  
PROFESSIONALS